

# The Whitney Forum COVID-19 Game Plan



*FlinFlon*

THE WATER & THE WILD

# Whitney Forum Facility Guidelines

## Self-Screening

The health and safety of our employees and guests is our number one priority. All employees and guests are required to complete a self-screening tool before proceeding to work or their activity. Employees and guests are asked to stay home if they do not feel well. If you or anyone in your household is feeling sick, please do not come to the Whitney Forum.

## Social Distancing

The public health order requires that facilities implement measures to ensure members of the public at the facility are reasonably able to maintain a separation of at least two metres from other members of the public at the facility, excluding participants while they are actively engaging in a sporting activity or training. Employees and guests will be advised to practice physical distancing by standing at least 6 feet (two metres) away from other people throughout the facility or an extended stick length away on the ice as much as possible. Please be mindful of others "bubbles" and sit/stand only in designated areas. Enhanced traffic flow measures have been implemented to accommodate one-way traffic and ease congestion at entrances and exits where we ask that guests move quickly in and out.

## Face Coverings

At this time participants and guests are required to wear a mask while entering the facility until they reach the dressing room and again upon leaving the dressing room to exit the facility. Coaches and team officials are not required to wear masks while on the ice behind the bench, however it is strongly recommended. Off-ice coaches and team officials (managers, volunteers, and personnel) must wear a mask in the facility at all times.

*FlinFlon*

THE WATER & THE WILD





## **Sanitization**

When entering the Whitney Forum you are required to utilize the hand sanitizer stations. Hand sanitizer dispensers will be placed at key guest entrances and high contact areas. All high touch areas will be cleaned with increased frequency each day. Dressing rooms will be cleaned after every use. Public access washrooms will also be cleaned on a more regular basis when programming is taking place.

## **Timing**

Participants will not be able to enter the Whitney Forum until twenty (20) minutes prior to the start of their session and must vacate the premises within twenty (20) minutes after the session has concluded. Dressing rooms will be available to all participants twenty (20) minutes prior to their ice time for practices; however, participants are encouraged to come to the facility dressed for the ice to limit time in the dressing rooms.

## **Water Bottles**

All customers must bring their own water bottles or purchase drinks at the concession. No water fountains will be available to participants or spectators at this time.

## **Spitting**

Absolutely no spitting will be tolerated anywhere within the facility. You will be asked to leave the premises and may have your privileges for future programming suspended indefinitely.

## **Protocols**

If additional program specific protocols have been developed by your governing body they must be reviewed and followed by all participants and spectators. All users must adhere to the most current provincial health order and deviation from the public health order may result in the group being asked to leave the facility immediately and future ice rental privileges could be suspended indefinitely.

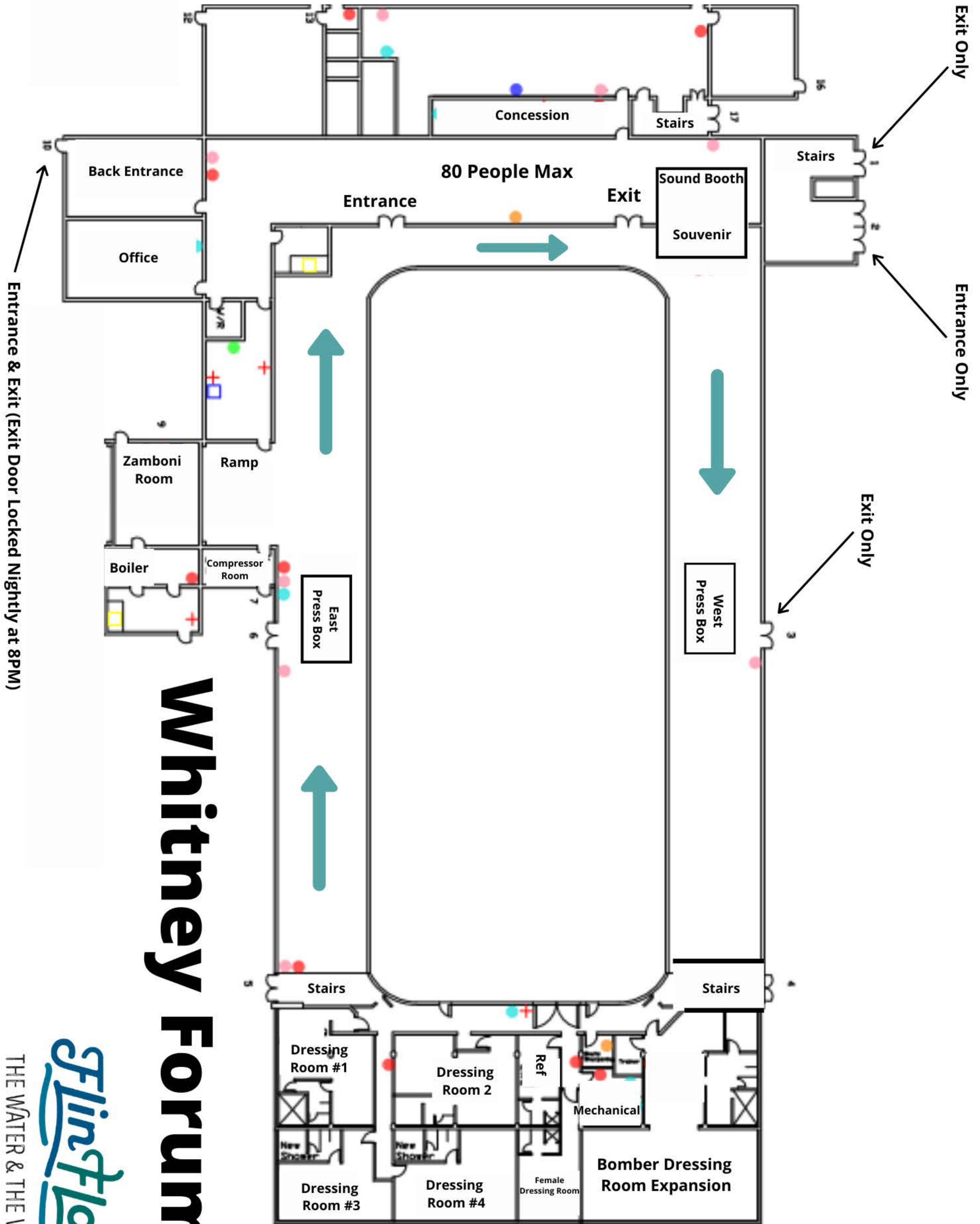

# Whitney Forum

*Flinston*

THE WATER & THE WILD





# COVID-19 PRECAUTIONS

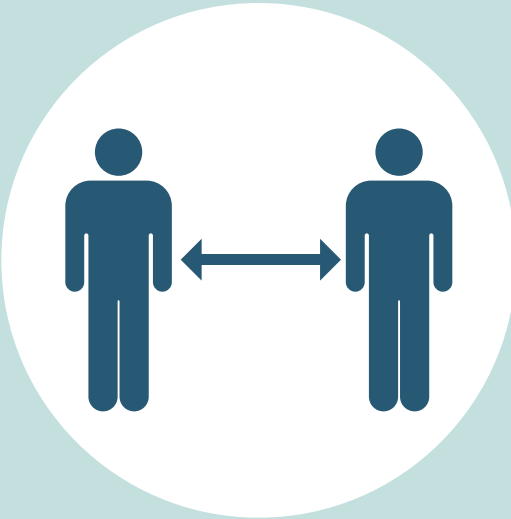

**Social Distancing.**  
Keep two meters apart.



**Cough or sneeze into a tissue or the  
bend of your arm, not your hands.**



**Wash your hands often with soap  
and water for at least 20 seconds.**



**Avoid greetings that involve  
touching, like handshakes.**



**Shared health**  
**Soins** communs  
Manitoba

**Manitoba**



# ATTENTION

Please respect  
physical distancing.

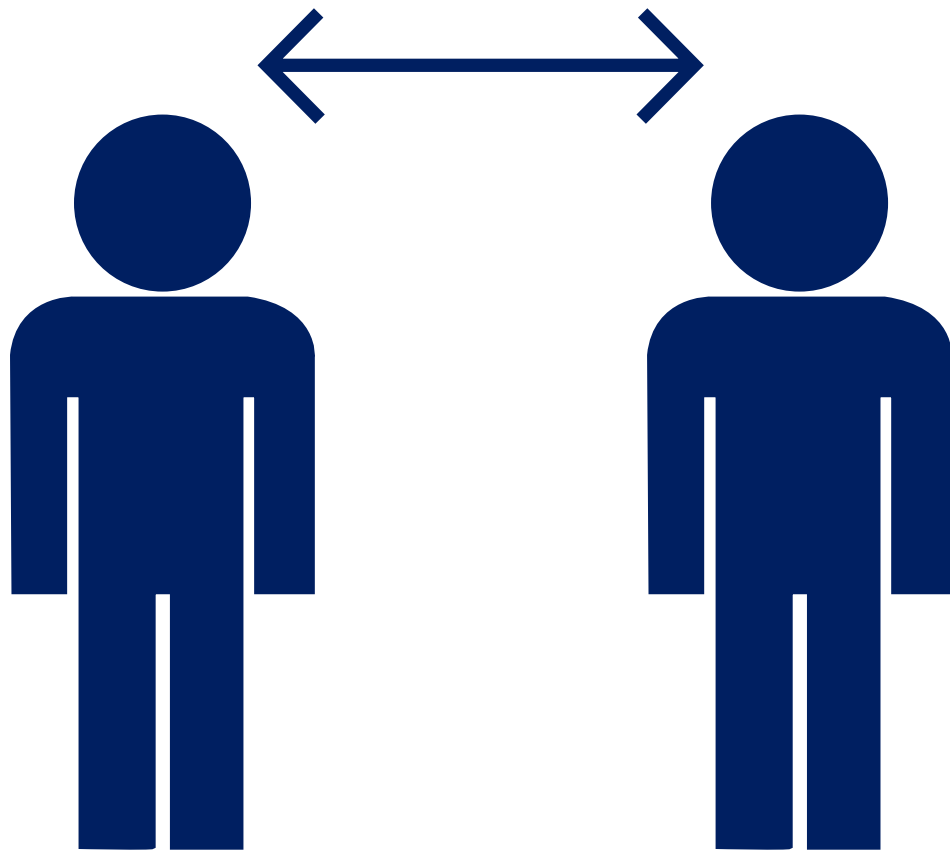

2m / 6ft



# HAND HYGIENE

## USING SOAP AND WATER

Use in all situations where soap and water are available

- Rinse hands with warm running water, add soap to palms and rub hands together to create lather
- Thoroughly cover all the surfaces of your hands and fingers (including nails) for 15 to 20 seconds
- Rinse under warm running water
- Dry hands thoroughly with single-use towel or hand dryer
- Turn off the tap with a clean paper towel

## USING AN ALCOHOL-BASED HAND RUB

Use when soap and water are NOT available, except if hands are visibly soiled

- Take a small amount of alcohol-based hand rub (about the size of a nickel)
- Rub it on your fingertips, both sides of your hands and between your fingers
- Continue to rub until your hands are dry
- There is no need to rinse or dry

Warning: The product is flammable when wet so ensure your hands are dry before performing another task.

HELP  
PREVENT  
THE SPREAD OF  
INFECTION